



## Mr Estimates

---

Dallas TX 75243  
www.mrestimatepro.com

Client: James & Geraldine Cillo  
Property: 17601 Marco  
Ft Myers , FL

Operator: CLIFFM

Estimator: Cliff Martin  
Position: Estimator  
Company: Mr. Estimates  
Business: 9330 LBJ Freeway Suite 900  
Dallas, TX 75243

E-mail: mrestimates1@gmail.com

Type of Estimate: Hurricane  
Date Entered: 12/28/2022                      Date Assigned:

Price List: FLNA8X\_DEC22  
Labor Efficiency: Restoration/Service/Remodel  
Estimate: 17601

This is scope of work is to reflect the effected area damage for Emergency Service due to CAT 3 flood water. There is a chance that during discovery additional area could be effected. All proper parties will be informed if need for change order.



**Mr Estimates**

Dallas TX 75243  
www.mrestimatepro.com

**17601  
Main Level**

**Main Level**

DESCRIPTION	QTY	REMOVE	REPLACE	TAX	O&P	TOTAL
1. Job-site moving/storage container - 20' long - per month	2.00 MO	0.00	222.60	26.71	94.38	566.29
2. Light bulb - LED A19 - up to 500 lm - material only	14.00 EA	0.00	6.14	5.16	18.24	109.36
3. Plumbing (Bid Item)	1.00 EA	0.00	0.00	0.00	0.00	0.00
4. Electrical (Bid Item)	1.00 EA	0.00	0.00	0.00	0.00	0.00
5. Temporary toilet (per month)	1.00 MO	0.00	895.00	0.00	179.00	1,074.00
6. Dumpster load - Approx. 30 yards, 5-7 tons of debris	2.00 EA	1,200.00	0.00	0.00	480.00	2,880.00
7. R&R Smoke detector	8.00 EA	15.91	74.22	12.35	146.70	880.09
<b>Total: Main Level</b>				<b>44.22</b>	<b>918.32</b>	<b>5,509.74</b>

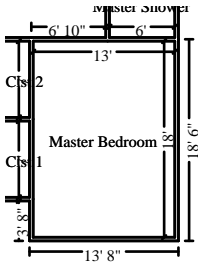

**Master Bedroom**

**Height: 10'**

620.00 SF Walls	234.00 SF Ceiling
854.00 SF Walls & Ceiling	234.00 SF Floor
26.00 SY Flooring	62.00 LF Floor Perimeter
62.00 LF Ceil. Perimeter	

DESCRIPTION	QTY	REMOVE	REPLACE	TAX	O&P	TOTAL
8. 1/2" - drywall per LF - up to 2' tall	62.00 LF	0.00	14.67	5.43	182.98	1,097.95
9. Batt insulation - 4" - R13 - paper / foil faced	104.00 SF	0.00	0.94	4.06	20.38	122.20
10. Mask and prep for paint - plastic, paper, tape (per LF)	62.00 LF	0.00	1.59	1.00	19.92	119.50
11. Clean cold air return cover	1.00 EA	0.00	11.32	0.00	2.26	13.58
12. R&R Carpet - High grade	234.00 SF	0.40	5.77	65.71	301.90	1,811.39
13. R&R Carpet pad	234.00 SF	0.17	0.67	7.16	40.76	244.48
14. R&R Outlet	5.00 EA	7.22	21.39	0.51	28.72	172.28
15. Contents - move out then reset - Large room	5.00 EA	0.00	115.57	0.00	115.58	693.43
16. Snaplock Laminate - simulated wood flooring	234.00 SF	0.00	6.76	43.95	325.16	1,950.95
17. Clean ceiling fan and light	1.00 EA	0.00	33.86	0.00	6.78	40.64
18. R&R Interior door unit	1.00 EA	26.90	342.49	15.86	77.06	462.31



**Mr Estimates**

Dallas TX 75243  
www.mrestimatepro.com

**CONTINUED - Master Bedroom**

DESCRIPTION	QTY	REMOVE	REPLACE	TAX	O&P	TOTAL
19. Paint door slab only - 2 coats (per side)	1.00 EA	0.00	44.70	0.61	9.06	54.37
20. Paint door/window trim & jamb - 2 coats (per side)	1.00 EA	0.00	37.06	0.36	7.50	44.92
21. Paint the walls - two coats	620.00 SF	0.00	1.17	11.53	147.38	884.31
22. Baseboard - 3 1/4"	62.00 LF	0.00	4.53	7.11	57.60	345.57
23. Paint baseboard - two coats	62.00 LF	0.00	1.69	0.63	21.08	126.49
24. Sub floor bracing	1.00 SF	0.00	0.00	0.00	0.00	0.00
25. Tear out subfloor & bag for disposal - Category 3	234.00 SF	3.08	0.00	1.26	144.40	866.38
26. R&R Door opening (jamb & casing) - 32"to36"wide - stain grade	1.00 EA	9.02	246.64	10.72	53.26	319.64
<b>Totals: Master Bedroom</b>				<b>175.90</b>	<b>1,561.78</b>	<b>9,370.39</b>

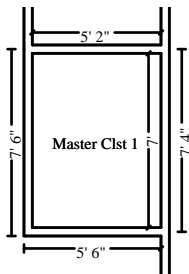

**Master Clst 1**

**Height: 8'**

194.67 SF Walls	36.17 SF Ceiling
230.83 SF Walls & Ceiling	36.17 SF Floor
4.02 SY Flooring	24.33 LF Floor Perimeter
24.33 LF Ceil. Perimeter	

DESCRIPTION	QTY	REMOVE	REPLACE	TAX	O&P	TOTAL
27. 1/2" - drywall per LF - up to 2' tall	24.33 LF	0.00	14.67	2.13	71.80	430.85
28. Batt insulation - 4" - R13 - paper / foil faced	48.66 SF	0.00	0.94	1.90	9.52	57.16
29. Mask and prep for paint - plastic, paper, tape (per LF)	24.33 LF	0.00	1.59	0.39	7.82	46.89
30. Paint the walls - two coats	194.67 SF	0.00	1.17	3.62	46.28	277.66
31. Baseboard - 3 1/4"	24.33 LF	0.00	4.53	2.79	22.60	135.60
32. Paint baseboard - two coats	24.33 LF	0.00	1.69	0.25	8.28	49.65
33. R&R Interior door unit	1.00 EA	26.90	342.49	15.86	77.06	462.31
34. Paint door slab only - 2 coats (per side)	1.00 EA	0.00	44.70	0.61	9.06	54.37
35. Paint door/window trim & jamb - 2 coats (per side)	1.00 EA	0.00	37.06	0.36	7.50	44.92
36. Clean ceiling fan and light	1.00 EA	0.00	33.86	0.00	6.78	40.64
37. Snaplock Laminate - simulated wood flooring	36.17 SF	0.00	6.76	6.79	50.26	301.56



**Mr Estimates**

Dallas TX 75243  
www.mrestimatepro.com

**CONTINUED - Master Clst 1**

DESCRIPTION	QTY	REMOVE	REPLACE	TAX	O&P	TOTAL
38. Contents - move out then reset - Large room	5.00 EA	0.00	115.57	0.00	115.58	693.43
39. R&R Outlet	5.00 EA	7.22	21.39	0.51	28.72	172.28
40. R&R Carpet pad	36.17 SF	0.17	0.67	1.11	6.30	37.79
41. R&R Carpet - High grade	36.17 SF	0.40	5.77	10.16	46.68	280.01
42. Clean cold air return cover	1.00 EA	0.00	11.32	0.00	2.26	13.58
43. Tear out subfloor & bag for disposal - Category 3	36.17 SF	3.08	0.00	0.20	22.32	133.92
44. Closet rod - Detach & reset	24.33 LF	0.00	3.30	0.00	16.06	96.35
45. Light fixture - Detach & reset	1.00 EA	0.00	75.68	0.00	15.14	90.82
46. Light bulb - LED A19 - up to 500 lm - material only	1.00 EA	0.00	6.14	0.37	1.30	7.81
47. Subfloor Bracing	31.50 SF	0.00	4.15	7.84	27.70	166.27
48. R&R Door opening (jamb & casing) - 32"to36"wide - stain grade	1.00 EA	9.02	246.64	10.72	53.26	319.64
<b>Totals: Master Clst 1</b>				<b>65.61</b>	<b>652.28</b>	<b>3,913.51</b>

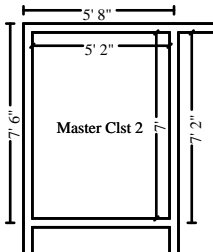

**Master Clst 2**

**Height: 8'**

- 194.67 SF Walls
- 230.83 SF Walls & Ceiling
- 4.02 SY Flooring
- 24.33 LF Ceil. Perimeter
- 36.17 SF Ceiling
- 36.17 SF Floor
- 24.33 LF Floor Perimeter

DESCRIPTION	QTY	REMOVE	REPLACE	TAX	O&P	TOTAL
49. 1/2" - drywall per LF - up to 2' tall	24.33 LF	0.00	14.67	2.13	71.80	430.85
50. Batt insulation - 4" - R13 - paper / foil faced	48.66 SF	0.00	0.94	1.90	9.52	57.16
51. Mask and prep for paint - plastic, paper, tape (per LF)	24.33 LF	0.00	1.59	0.39	7.82	46.89
52. Paint the walls - two coats	194.67 SF	0.00	1.17	3.62	46.28	277.66
53. Baseboard - 3 1/4"	24.33 LF	0.00	4.53	2.79	22.60	135.60
54. Paint baseboard - two coats	24.33 LF	0.00	1.69	0.25	8.28	49.65
55. R&R Interior door unit	1.00 EA	26.90	342.49	15.86	77.06	462.31
56. Paint door slab only - 2 coats (per side)	1.00 EA	0.00	44.70	0.61	9.06	54.37
57. Paint door/window trim & jamb - 2 coats (per side)	1.00 EA	0.00	37.06	0.36	7.50	44.92



**Mr Estimates**

Dallas TX 75243  
www.mrestimatepro.com

**CONTINUED - Master Clst 2**

DESCRIPTION	QTY	REMOVE	REPLACE	TAX	O&P	TOTAL
58. Clean ceiling fan and light	1.00 EA	0.00	33.86	0.00	6.78	40.64
59. Snaplock Laminate - simulated wood flooring	36.17 SF	0.00	6.76	6.79	50.26	301.56
60. Contents - move out then reset - Large room	5.00 EA	0.00	115.57	0.00	115.58	693.43
61. R&R Outlet	5.00 EA	7.22	21.39	0.51	28.72	172.28
62. R&R Carpet pad	36.17 SF	0.17	0.67	1.11	6.30	37.79
63. R&R Carpet - High grade	36.17 SF	0.40	5.77	10.16	46.68	280.01
64. Clean cold air return cover	1.00 EA	0.00	11.32	0.00	2.26	13.58
65. Tear out subfloor & bag for disposal - Category 3	36.17 SF	3.08	0.00	0.20	22.32	133.92
66. Closet rod - Detach & reset	24.33 LF	0.00	3.30	0.00	16.06	96.35
67. Light fixture - Detach & reset	1.00 EA	0.00	75.68	0.00	15.14	90.82
68. Light bulb - LED A19 - up to 500 lm - material only	1.00 EA	0.00	6.14	0.37	1.30	7.81
69. Subfloor Bracing	31.50 SF	0.00	4.15	7.84	27.70	166.27
70. R&R Door opening (jamb & casing) - 32"to36"wide - stain grade	1.00 EA	9.02	246.64	10.72	53.26	319.64
<b>Totals: Master Clst 2</b>				<b>65.61</b>	<b>652.28</b>	<b>3,913.51</b>

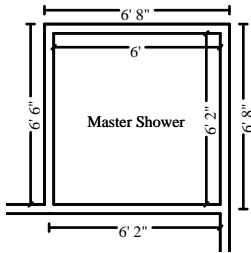

**Master Shower**

**Height: 8'**

194.67 SF Walls	37.00 SF Ceiling
231.67 SF Walls & Ceiling	37.00 SF Floor
4.11 SY Flooring	24.33 LF Floor Perimeter
24.33 LF Ceil. Perimeter	

DESCRIPTION	QTY	REMOVE	REPLACE	TAX	O&P	TOTAL
71. R&R Door knob - interior	1.00 EA	17.94	46.10	1.28	13.06	78.38
72. R&R Fir subfloor - no finish	37.00 SF	3.36	8.00	8.06	85.68	514.06
73. Final cleaning - construction - Residential	37.00 SF	0.00	0.34	0.00	2.52	15.10
74. Apply plant-based anti-microbial agent to the floor	37.00 SF	0.00	0.33	0.11	2.46	14.78
75. Subfloor Bracing	31.50 SF	0.00	4.15	7.84	27.70	166.27
76. Tear out subfloor & bag for disposal - Category 3	37.00 SF	3.08	0.00	0.20	22.84	137.00



**Mr Estimates**

Dallas TX 75243  
www.mrestimatepro.com

**CONTINUED - Master Shower**

DESCRIPTION	QTY	REMOVE	REPLACE	TAX	O&P	TOTAL
77. Paint door/window trim & jamb - 2 coats (per side)	1.00 EA	0.00	37.06	0.36	7.50	44.92
78. Paint door slab only - 2 coats (per side)	1.00 EA	0.00	44.70	0.61	9.06	54.37
79. Interior door unit	1.00 EA	0.00	342.49	15.86	71.68	430.03
80. Vinyl tile	37.00 SF	0.00	4.20	5.04	32.08	192.52
81. Tile shower - up to 60 SF	1.00 EA	0.00	1,300.23	23.68	264.78	1,588.69
82. Clean window blind - horizontal or vertical	1.00 SF	0.00	1.68	0.00	0.34	2.02
83. Baseboard - 3 1/4"	24.33 LF	0.00	4.53	2.79	22.60	135.60
84. Bathroom ventilation fan w/light	1.00 EA	0.00	175.94	7.19	36.62	219.75
85. Mask and prep for paint - plastic, paper, tape (per LF)	24.33 LF	0.00	1.59	0.39	7.82	46.89
86. Paint the walls - two coats	194.67 SF	0.00	1.17	3.62	46.28	277.66
87. Paint baseboard - two coats	24.33 LF	0.00	1.69	0.25	8.28	49.65
88. R&R 1/2" drywall - hung, taped, floated, ready for paint	194.67 SF	0.60	22.00	7.48	881.40	5,288.42
89. Tub/shower faucet	1.00 EA	0.00	332.08	8.40	68.10	408.58
90. Toilet seat	1.00 EA	0.00	59.54	1.89	12.28	73.71
91. Toilet	1.00 EA	0.00	547.59	18.26	113.18	679.03
92. Subfloor Bracing	31.50 SF	0.00	4.15	7.84	27.70	166.27
93. R&R Door opening (jamb & casing) - 32"to36"wide - stain grade	1.00 EA	9.02	246.64	10.72	53.26	319.64
Totals: Master Shower				131.87	1,817.22	10,903.34

**Master Bath**

**Height: 8'**

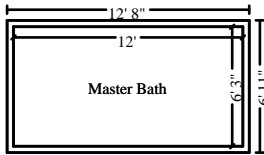

292.00 SF Walls	75.00 SF Ceiling
367.00 SF Walls & Ceiling	75.00 SF Floor
8.33 SY Flooring	36.50 LF Floor Perimeter
36.50 LF Ceil. Perimeter	

DESCRIPTION	QTY	REMOVE	REPLACE	TAX	O&P	TOTAL
94. Mask and prep for paint - plastic, paper, tape (per LF)	36.50 LF	0.00	1.59	0.59	11.72	70.35
95. 1/2" - drywall per LF - up to 2' tall	36.50 LF	0.00	22.00	3.20	161.24	967.44
96. Batt insulation - 4" - R13 - paper / foil faced	73.00 SF	0.00	0.94	2.85	14.30	85.77



Mr Estimates

Dallas TX 75243
www.mrestimatepro.com

CONTINUED - Master Bath

Table with 7 columns: DESCRIPTION, QTY, REMOVE, REPLACE, TAX, O&P, TOTAL. Rows include items like 'Seal/prime then paint the walls', 'Door knob - interior', 'Interior door unit', etc., ending with a 'Totals: Master Bath' row.



**Mr Estimates**

Dallas TX 75243  
www.mrestimatepro.com

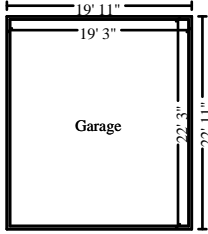

**Garage**

**Height: 8'**

664.00 SF Walls	428.31 SF Ceiling
1,092.31 SF Walls & Ceiling	428.31 SF Floor
47.59 SY Flooring	83.00 LF Floor Perimeter
83.00 LF Ceil. Perimeter	

DESCRIPTION	QTY	REMOVE	REPLACE	TAX	O&P	TOTAL
119. Final cleaning - construction - Residential	428.31 SF	0.00	0.34	0.00	29.12	174.75
120. Seal & paint single garage door opening & trim	1.00 EA	0.00	116.88	0.56	23.50	140.94
121. R&R Water heater - 40 gallon - Gas - 6 yr	1.00 EA	82.95	1,144.44	40.47	253.58	1,521.44
122. R&R 4" x 4" x 8' wood post - turned	8.00 EA	24.39	115.88	35.40	231.50	1,389.06
123. R&R 2" x 2" lumber - treated (.33 BF per LF)	130.00 LF	0.78	2.75	4.91	92.76	556.57
124. R&R 2" x 6" lumber (1 BF per LF)	40.00 LF	0.86	3.89	3.70	38.74	232.44
125. R&R Sheathing - OSB - 5/8"	240.00 SF	0.81	2.01	13.10	137.98	827.88
126. R&R 2" x 4" lumber (.667 BF per LF)	150.00 LF	0.78	3.39	9.36	126.98	761.84
127. Seal & paint wood beam	240.00 SF	0.00	2.29	3.74	110.66	664.00
128. R&R Water heater overflow drain pan	1.00 EA	8.97	56.09	1.46	13.32	79.84
129. R&R Patio door screen, 48" wide	4.00 EA	7.22	115.76	26.37	103.66	621.95
130. R&R Overhead door & hardware - 16' x 7'	1.00 EA	119.55	1,805.27	81.97	401.38	2,408.17
131. Subfloor Bracing	31.50 SF	0.00	4.15	7.84	27.70	166.27
132. R&R Door opening (jamb & casing) - 32"to36"wide - stain grade	1.00 EA	9.02	246.64	10.72	53.26	319.64
<b>Totals: Garage</b>				<b>239.60</b>	<b>1,644.14</b>	<b>9,864.79</b>

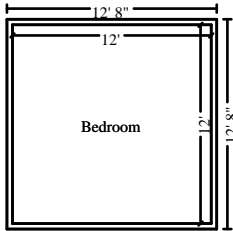

**Bedroom**

**Height: 8'**

384.00 SF Walls	144.00 SF Ceiling
528.00 SF Walls & Ceiling	144.00 SF Floor
16.00 SY Flooring	48.00 LF Floor Perimeter
48.00 LF Ceil. Perimeter	

DESCRIPTION	QTY	REMOVE	REPLACE	TAX	O&P	TOTAL
-------------	-----	--------	---------	-----	-----	-------





**Mr Estimates**

Dallas TX 75243  
www.mrestimatepro.com

**CONTINUED - Bedroom**

DESCRIPTION	QTY	REMOVE	REPLACE	TAX	O&P	TOTAL
133. R&R Door knob - interior	1.00 EA	17.94	46.10	1.28	13.06	78.38
134. R&R Fir subfloor - no finish	144.00 SF	3.36	8.00	31.36	333.44	2,000.64
135. Contents - move out then reset - Large room	1.00 EA	0.00	115.57	0.00	23.12	138.69
136. Final cleaning - construction - Residential	144.00 SF	0.00	0.34	0.00	9.80	58.76
137. Apply plant-based anti-microbial agent to the floor	144.00 SF	0.00	0.33	0.43	9.58	57.53
138. Tear out subfloor & bag for disposal - Category 3	144.00 SF	3.08	0.00	0.78	88.86	533.16
139. Clean ceiling fan and light - Heavy	1.00 EA	0.00	48.34	0.00	9.66	58.00
140. Paint baseboard - two coats	48.00 LF	0.00	1.69	0.49	16.32	97.93
141. Baseboard - 3 1/4"	48.00 LF	0.00	4.53	5.50	44.58	267.52
142. Seal/prime then paint the walls (2 coats)	384.00 SF	0.00	5.00	5.30	385.06	2,310.36
143. Batt insulation - 4" - R13 - paper / foil faced	92.00 SF	0.00	0.94	3.59	18.02	108.09
144. 1/2" - drywall per LF - up to 2' tall	48.00 LF	0.00	22.00	4.20	212.04	1,272.24
145. Mask and prep for paint - plastic, paper, tape (per LF)	48.00 LF	0.00	1.59	0.78	15.42	92.52
146. Subfloor Bracing	31.50 SF	0.00	4.15	7.84	27.70	166.27
147. R&R Door opening (jamb & casing) - 32"to36"wide - stain grade	1.00 EA	9.02	246.64	10.72	53.26	319.64
148. Snaplock Laminate - simulated wood flooring	144.00 SF	0.00	6.76	27.04	200.08	1,200.56
<b>Totals: Bedroom</b>				99.31	1,460.00	8,760.29

**Bedroom Clst**

**Height: 8'**

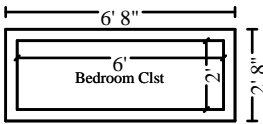

128.00 SF Walls	12.00 SF Ceiling
140.00 SF Walls & Ceiling	12.00 SF Floor
1.33 SY Flooring	16.00 LF Floor Perimeter
16.00 LF Ceil. Perimeter	

DESCRIPTION	QTY	REMOVE	REPLACE	TAX	O&P	TOTAL
149. Paint full lvrld bifold door set - slab - 2 coats -per side	1.00 EA	0.00	95.65	1.20	19.38	116.23
150. R&R Bifold door set - full louvered - Double	1.00 EA	21.52	501.37	21.29	108.84	653.02



**Mr Estimates**

Dallas TX 75243  
www.mrestimatepro.com

**CONTINUED - Bedroom Clst**

DESCRIPTION	QTY	REMOVE	REPLACE	TAX	O&P	TOTAL
151. Closet shelf and rod package - Detach & reset	16.00 LF	0.00	14.30	0.00	45.76	274.56
152. R&R Fir subfloor - no finish	12.00 SF	3.36	8.00	2.61	27.78	166.71
153. Final cleaning - construction - Residential	12.00 SF	0.00	0.34	0.00	0.82	4.90
154. Apply plant-based anti-microbial agent to the floor	12.00 SF	0.00	0.33	0.04	0.80	4.80
155. Tear out subfloor & bag for disposal - Category 3	12.00 SF	3.08	0.00	0.06	7.42	44.44
156. Paint baseboard - two coats	16.00 LF	0.00	1.69	0.16	5.44	32.64
157. Baseboard - 3 1/4"	16.00 LF	0.00	4.53	1.83	14.86	89.17
158. Seal/prime then paint the walls (2 coats)	128.00 SF	0.00	5.00	1.77	128.36	770.13
159. Batt insulation - 4" - R13 - paper / foil faced	34.34 SF	0.00	0.94	1.34	6.72	40.34
160. 1/2" - drywall per LF - up to 2' tall	16.00 LF	0.00	22.00	1.40	70.68	424.08
161. Mask and prep for paint - plastic, paper, tape (per LF)	16.00 LF	0.00	1.59	0.26	5.14	30.84
162. Subfloor Bracing	31.50 SF	0.00	4.15	7.84	27.70	166.27
163. R&R Door opening (jamb & casing) - 32"to36"wide - stain grade	1.00 EA	9.02	246.64	10.72	53.26	319.64
164. Snaplock Laminate - simulated wood flooring	12.00 SF	0.00	6.76	2.25	16.68	100.05
<b>Totals: Bedroom Clst</b>				<b>52.77</b>	<b>539.64</b>	<b>3,237.82</b>

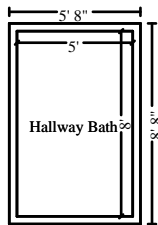

**Hallway Bath**

**Height: 8'**

208.00 SF Walls	40.00 SF Ceiling
248.00 SF Walls & Ceiling	40.00 SF Floor
4.44 SY Flooring	26.00 LF Floor Perimeter
26.00 LF Ceil. Perimeter	

DESCRIPTION	QTY	REMOVE	REPLACE	TAX	O&P	TOTAL
165. Mask and prep for paint - plastic, paper, tape (per LF)	26.00 LF	0.00	1.59	0.42	8.34	50.10
166. 1/2" - drywall per LF - up to 2' tall	26.00 LF	0.00	22.00	2.28	114.86	689.14
167. Batt insulation - 4" - R13 - paper / foil faced	208.00 SF	0.00	0.94	8.11	40.72	244.35



Mr Estimates

Dallas TX 75243
www.mrestimatepro.com

CONTINUED - Hallway Bath

Table with 7 columns: DESCRIPTION, QTY, REMOVE, REPLACE, TAX, O&P, TOTAL. Rows 168-192 and a Totals row for Hallway Bath.



# Mr Estimates

Dallas TX 75243  
www.mrestimatepro.com



## Kitfchen

**Height: 8'**

464.00 SF Walls	180.00 SF Ceiling
644.00 SF Walls & Ceiling	180.00 SF Floor
20.00 SY Flooring	58.00 LF Floor Perimeter
58.00 LF Ceil. Perimeter	

DESCRIPTION	QTY	REMOVE	REPLACE	TAX	O&P	TOTAL
193. R&R Cabinetry - upper (wall) units	15.00 LF	10.78	183.45	117.60	606.22	3,637.27
194. Refrigerator - side by side - 22 to 25 cf	1.00 EA	0.00	1,645.65	96.00	348.34	2,089.99
195. Dishwasher - High grade	1.00 EA	0.00	1,000.59	50.91	210.30	1,261.80
196. Cabinetry - lower (base) units	18.00 LF	0.00	271.68	236.41	1,025.32	6,151.97
197. Clean ceiling fan and light	1.00 EA	0.00	33.86	0.00	6.78	40.64
198. Clean cabinetry - upper - inside and out	20.00 LF	0.00	19.18	0.11	76.74	460.45
199. Garbage disposer	1.00 EA	0.00	270.95	8.39	55.88	335.22
200. Range - freestanding - gas	1.00 EA	0.00	1,176.29	60.00	247.26	1,483.55
201. Countertop - solid surface	20.00 SF	0.00	69.86	53.64	290.16	1,741.00
202. R&R Fir subfloor - no finish	180.00 SF	3.36	8.00	39.20	416.80	2,500.80
203. R&R P-trap assembly - ABS (plastic)	1.00 EA	10.76	71.63	0.48	16.58	99.45
204. Final cleaning - construction - Residential	180.00 SF	0.00	0.34	0.00	12.24	73.44
205. Apply plant-based anti-microbial agent to the floor	180.00 SF	0.00	0.33	0.54	11.98	71.92
206. Tear out subfloor & bag for disposal - Category 3	180.00 SF	3.08	0.00	0.97	111.08	666.45
207. Outlet	5.00 EA	0.00	21.39	0.51	21.50	128.96
208. Material Only Vinyl floor covering (sheet goods)	207.00 SF	0.00	1.75	21.74	76.80	460.79
209. Countertop subdeck - plywood	180.00 SF	0.00	4.28	19.01	157.88	947.29
210. Paint baseboard - two coats	58.00 LF	0.00	1.69	0.59	19.72	118.33
211. Baseboard - 3 1/4"	58.00 LF	0.00	4.53	6.65	53.88	323.27
212. Sink - double basin - Standard grade	1.00 EA	0.00	318.74	10.95	65.94	395.63
213. Seal/prime then paint the walls (2 coats)	464.00 SF	0.00	5.00	6.40	465.28	2,791.68
214. Batt insulation - 4" - R13 - paper / foil faced	116.00 SF	0.00	0.94	4.52	22.70	136.26
215. 1/2" - drywall per LF - up to 2' tall	58.00 LF	0.00	22.00	5.08	256.22	1,537.30



**Mr Estimates**

Dallas TX 75243  
www.mrestimatepro.com

**CONTINUED - Kitfchen**

DESCRIPTION	QTY	REMOVE	REPLACE	TAX	O&P	TOTAL
216. Mask and prep for paint - plastic, paper, tape (per LF)	58.00 LF	0.00	1.59	0.94	18.62	111.78
217. Subfloor Bracing	31.50 SF	0.00	4.15	7.84	27.70	166.27
218. Snaplock Laminate - simulated wood flooring	180.00 SF	0.00	6.76	33.80	250.12	1,500.72
<b>Totals: Kitfchen</b>				<b>782.28</b>	<b>4,872.04</b>	<b>29,232.23</b>

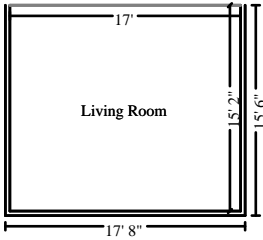

**Living Room**

**Height: 12'**

568.00 SF Walls	257.83 SF Ceiling
825.83 SF Walls & Ceiling	257.83 SF Floor
28.65 SY Flooring	47.33 LF Floor Perimeter
47.33 LF Ceil. Perimeter	

**Missing Wall**

**17' X 12'**

**Opens into Exterior**

DESCRIPTION	QTY	REMOVE	REPLACE	TAX	O&P	TOTAL
219. Mask and prep for paint - plastic, paper, tape (per LF)	47.33 LF	0.00	1.59	0.77	15.22	91.24
220. 1/2" - drywall per LF - up to 2' tall	47.33 LF	0.00	22.00	4.15	209.10	1,254.51
221. Batt insulation - 4" - R13 - paper / foil faced	94.66 SF	0.00	0.94	3.69	18.54	111.21
222. Seal/prime then paint the walls (2 coats)	568.00 SF	0.00	5.00	7.84	569.56	3,417.40
223. Baseboard - 3 1/4"	47.33 LF	0.00	4.53	5.42	43.96	263.78
224. Paint baseboard - two coats	47.33 LF	0.00	1.69	0.48	16.10	96.57
225. R&R Outlet	5.00 EA	7.22	21.39	0.51	28.72	172.28
226. Tear out subfloor & bag for disposal - Category 3	257.83 SF	3.08	0.00	1.39	159.10	954.61
227. Apply plant-based anti-microbial agent to the floor	257.83 SF	0.00	0.33	0.77	17.18	103.03
228. Final cleaning - construction - Residential	257.83 SF	0.00	0.34	0.00	17.54	105.20
229. Contents - move out then reset - Extra large room	4.00 EA	0.00	231.15	0.00	184.92	1,109.52
230. R&R Fir subfloor - no finish	257.83 SF	3.36	8.00	56.16	597.02	3,582.13
231. R&R Door knob - interior	1.00 EA	17.94	46.10	1.28	13.06	78.38
232. R&R 6-0 6-8 vinyl sliding patio door	1.00 EA	53.79	1,046.24	46.16	229.24	1,375.43
233. R&R Patio door screen, 48" wide	2.00 EA	7.22	115.76	13.18	51.82	310.96



**Mr Estimates**

Dallas TX 75243  
www.mrestimatepro.com

**CONTINUED - Living Room**

DESCRIPTION	QTY	REMOVE	REPLACE	TAX	O&P	TOTAL
234. Subfloor Bracing	31.50 SF	0.00	4.15	7.84	27.70	166.27
235. Clean chandelier - with crystal - Heavy	1.00 EA	0.00	270.49	0.01	54.10	324.60
236. Clean ceiling fan and light	1.00 EA	0.00	33.86	0.00	6.78	40.64
237. Clean cold air return cover	2.00 EA	0.00	11.32	0.01	4.52	27.17
238. Snaplock Laminate - simulated wood flooring	257.83 SF	0.00	6.76	48.42	358.26	2,149.61
Totals: Living Room				198.08	2,622.44	15,734.54

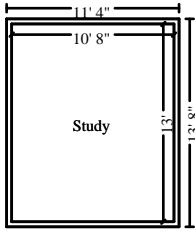

**Study**

**Height: 8'**

378.67 SF Walls	138.67 SF Ceiling
517.33 SF Walls & Ceiling	138.67 SF Floor
15.41 SY Flooring	47.33 LF Floor Perimeter
47.33 LF Ceil. Perimeter	

DESCRIPTION	QTY	REMOVE	REPLACE	TAX	O&P	TOTAL
239. R&R Door knob - interior	1.00 EA	17.94	46.10	1.28	13.06	78.38
240. R&R Fir subfloor - no finish	138.67 SF	3.36	8.00	30.20	321.10	1,926.59
241. Final cleaning - construction - Residential	138.67 SF	0.00	0.34	0.00	9.44	56.59
242. Apply plant-based anti-microbial agent to the floor	138.67 SF	0.00	0.33	0.42	9.24	55.42
243. Tear out subfloor & bag for disposal - Category 3	138.67 SF	3.08	0.00	0.75	85.58	513.43
244. Outlet	5.00 EA	0.00	21.39	0.51	21.50	128.96
245. Clean ceiling fan and light - Heavy	1.00 EA	0.00	48.34	0.00	9.66	58.00
246. Paint baseboard - two coats	47.33 LF	0.00	1.69	0.48	16.10	96.57
247. Baseboard - 3 1/4"	47.33 LF	0.00	4.53	5.42	43.96	263.78
248. Seal/prime then paint the walls (2 coats)	378.67 SF	0.00	5.00	5.23	379.72	2,278.30
249. Batt insulation - 4" - R13 - paper / foil faced	94.66 SF	0.00	0.94	3.69	18.54	111.21
250. 1/2" - drywall per LF - up to 2' tall	47.33 LF	0.00	22.00	4.15	209.10	1,254.51
251. Mask and prep for paint - plastic, paper, tape (per LF)	47.33 LF	0.00	1.59	0.77	15.22	91.24
252. Subfloor Bracing	31.50 SF	0.00	4.15	7.84	27.70	166.27



**Mr Estimates**

Dallas TX 75243  
www.mrestimatepro.com

**CONTINUED - Study**

DESCRIPTION	QTY	REMOVE	REPLACE	TAX	O&P	TOTAL
253. R&R Door opening (jamb & casing) - 36"to60"wide - stain grade	1.00 EA	9.02	286.71	12.31	61.60	369.64
254. R&R Interior double door - Colonist - pre-hung unit	2.00 EA	30.74	586.60	56.32	258.20	1,549.20
255. Paint door slab only - 2 coats (per side)	2.00 EA	0.00	44.70	1.23	18.12	108.75
256. Paint door/window trim & jamb - 2 coats (per side)	2.00 EA	0.00	37.06	0.72	14.96	89.80
257. Snaplock Laminate - simulated wood flooring	138.67 SF	0.00	6.76	26.04	192.68	1,156.13
Totals: Study				157.36	1,725.48	10,352.77

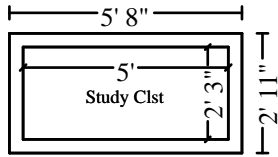

**Study Clst**

**Height: 8'**

116.00 SF Walls	11.25 SF Ceiling
127.25 SF Walls & Ceiling	11.25 SF Floor
1.25 SY Flooring	14.50 LF Floor Perimeter
14.50 LF Ceil. Perimeter	

DESCRIPTION	QTY	REMOVE	REPLACE	TAX	O&P	TOTAL
258. Paint full lvr'd bifold door set - slab - 2 coats -per side	1.00 EA	0.00	95.65	1.20	19.38	116.23
259. R&R Bifold door set - full louvered - Double	1.00 EA	21.52	501.37	21.29	108.84	653.02
260. Closet shelf and rod package - Detach & reset	14.50 LF	0.00	14.30	0.00	41.48	248.83
261. R&R Fir subfloor - no finish	11.25 SF	3.36	8.00	2.45	26.06	156.31
262. Contents - move out then reset - Small room	1.00 EA	0.00	57.84	0.00	11.56	69.40
263. Final cleaning - construction - Residential	11.25 SF	0.00	0.34	0.00	0.76	4.59
264. Apply plant-based anti-microbial agent to the floor	11.25 SF	0.00	0.33	0.03	0.74	4.48
265. Tear out subfloor & bag for disposal - Category 3	11.25 SF	3.08	0.00	0.06	6.96	41.67
266. Clean closet organizer and rod	1.00 EA	0.00	48.90	0.08	9.80	58.78
267. Paint baseboard - two coats	14.50 LF	0.00	1.69	0.15	4.94	29.60
268. Baseboard - 3 1/4"	14.50 LF	0.00	4.53	1.66	13.48	80.83
269. Seal/prime then paint the walls (2 coats)	116.00 SF	0.00	5.00	1.60	116.32	697.92



**Mr Estimates**

Dallas TX 75243  
www.mrestimatepro.com

**CONTINUED - Study Clst**

DESCRIPTION	QTY	REMOVE	REPLACE	TAX	O&P	TOTAL
270. Batt insulation - 4" - R13 - paper / foil faced	29.00 SF	0.00	0.94	1.13	5.68	34.07
271. 1/2" - drywall per LF - up to 2' tall	14.50 LF	0.00	22.00	1.27	64.06	384.33
272. Mask and prep for paint - plastic, paper, tape (per LF)	14.50 LF	0.00	1.59	0.24	4.66	27.96
273. Subfloor Bracing	31.50 SF	0.00	4.15	7.84	27.70	166.27
274. Snaplock Laminate - simulated wood flooring	11.25 SF	0.00	6.76	2.11	15.64	93.80
<b>Totals: Study Clst</b>				<b>41.11</b>	<b>478.06</b>	<b>2,868.09</b>

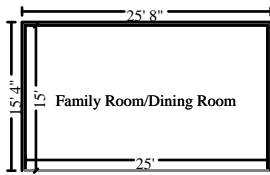

**Family Room/Dining Room**

**Height: 12'**

660.00 SF Walls	375.00 SF Ceiling
1,035.00 SF Walls & Ceiling	375.00 SF Floor
41.67 SY Flooring	55.00 LF Floor Perimeter
55.00 LF Ceil. Perimeter	

**Missing Wall**

**25' X 12'**

**Opens into Exterior**

DESCRIPTION	QTY	REMOVE	REPLACE	TAX	O&P	TOTAL
275. Clean chandelier	1.00 EA	0.00	56.40	0.01	11.28	67.69
276. Closet shelf and rod package - Detach & reset	55.00 LF	0.00	14.30	0.00	157.30	943.80
277. R&R Fir subfloor - no finish	375.00 SF	3.36	8.00	81.68	868.34	5,210.02
278. Contents - move out then reset - Extra large room	1.00 EA	0.00	231.15	0.00	46.24	277.39
279. Final cleaning - construction - Residential	375.00 SF	0.00	0.34	0.00	25.50	153.00
280. Apply plant-based anti-microbial agent to the floor	375.00 SF	0.00	0.33	1.13	24.98	149.86
281. Tear out subfloor & bag for disposal - Category 3	375.00 SF	3.08	0.00	2.03	231.40	1,388.43
282. Clean ceiling fan and light - Heavy	1.00 EA	0.00	48.34	0.00	9.66	58.00
283. Paint baseboard - two coats	55.00 LF	0.00	1.69	0.56	18.72	112.23
284. Baseboard - 3 1/4"	55.00 LF	0.00	4.53	6.30	51.10	306.55
285. Sink - double basin - Standard grade	1.00 EA	0.00	318.74	10.95	65.94	395.63
286. Seal/prime then paint the walls (2 coats)	660.00 SF	0.00	5.00	9.11	661.82	3,970.93





**Mr Estimates**

Dallas TX 75243  
www.mrestimatepro.com

**CONTINUED - Family Room/Dining Room**

DESCRIPTION	QTY	REMOVE	REPLACE	TAX	O&P	TOTAL
287. Batt insulation - 4" - R13 - paper / foil faced	110.00 SF	0.00	0.94	4.29	21.54	129.23
288. 1/2" - drywall per LF - up to 2' tall	55.00 LF	0.00	22.00	4.82	242.96	1,457.78
289. Mask and prep for paint - plastic, paper, tape (per LF)	55.00 LF	0.00	1.59	0.89	17.68	106.02
290. Subfloor Bracing	31.50 SF	0.00	4.15	7.84	27.70	166.27
291. Snaplock Laminate - simulated wood flooring	375.00 SF	0.00	6.76	70.43	521.08	3,126.51
<b>Totals: Family Room/Dining Room</b>				<b>200.04</b>	<b>3,003.24</b>	<b>18,019.34</b>

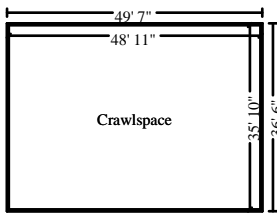

**Crawlspace**

**Height: 8'**

1,356.00 SF Walls	1,752.85 SF Ceiling
3,108.85 SF Walls & Ceiling	1,752.85 SF Floor
194.76 SY Flooring	169.50 LF Floor Perimeter
169.50 LF Ceil. Perimeter	

DESCRIPTION	QTY	REMOVE	REPLACE	TAX	O&P	TOTAL
292. Clean foundation wall	339.00 SF	0.00	0.71	0.41	48.22	289.32
293. Vapor barrier - 15# felt	1,752.85 SF	0.00	0.36	7.36	127.68	766.07
294. Moisture protection for crawl space - visqueen - 10 mil	1,752.85 SF	0.00	0.46	11.57	163.58	981.46
295. Moisture protection - vapor barrier seam tape	1,752.85 SF	0.00	0.14	3.16	49.72	298.28
296. Batt insulation - 4" - R13 - paper / foil faced	1,752.85 SF	0.00	0.94	68.36	343.22	2,059.26
297. Batt insulation - Add-on for confined spaces	1,752.85 SF	0.00	0.37	0.00	129.72	778.27
<b>Totals: Crawlspace</b>				<b>90.86</b>	<b>862.14</b>	<b>5,172.66</b>

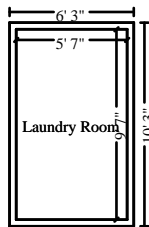

**Laundry Room**

**Height: 8'**

242.67 SF Walls	53.51 SF Ceiling
296.17 SF Walls & Ceiling	53.51 SF Floor
5.95 SY Flooring	30.33 LF Floor Perimeter
30.33 LF Ceil. Perimeter	



**Mr Estimates**

Dallas TX 75243  
www.mrestimatepro.com

**CONTINUED - Laundry Room**

DESCRIPTION	QTY	REMOVE	REPLACE	TAX	O&P	TOTAL
298. Subfloor Bracing	53.51 SF	0.00	0.00	0.00	0.00	0.00
299. R&R Fir subfloor - no finish	53.51 SF	3.36	8.00	11.65	123.92	743.44
300. Contents - move out then reset - Small room	1.00 EA	0.00	57.84	0.00	11.56	69.40
301. Final cleaning - construction - Residential	53.51 SF	0.00	0.34	0.00	3.64	21.83
302. Apply plant-based anti-microbial agent to the floor	53.51 SF	0.00	0.33	0.16	3.58	21.40
303. Tear out subfloor & bag for disposal - Category 3	53.51 SF	3.08	0.00	0.29	33.02	198.12
304. Clean closet organizer and rod	1.00 EA	0.00	48.90	0.08	9.80	58.78
305. R&R 5-0 6-8 vinyl sliding patio door	1.00 EA	53.79	963.38	41.18	211.68	1,270.03
306. Paint baseboard - two coats	30.33 LF	0.00	1.69	0.31	10.32	61.89
307. Baseboard - 3 1/4"	30.33 LF	0.00	4.53	3.48	28.18	169.05
308. Seal/prime then paint the walls (2 coats)	242.67 SF	0.00	5.00	3.35	243.36	1,460.06
309. Batt insulation - 4" - R13 - paper / foil faced	32.66 SF	0.00	0.94	1.27	6.40	38.37
310. 1/2" - drywall per LF - up to 2' tall	30.33 LF	0.00	14.67	2.66	89.52	537.12
311. Mask and prep for paint - plastic, paper, tape (per LF)	30.33 LF	0.00	1.59	0.49	9.74	58.45
312. Paint door/window trim & jamb - 2 coats (per side)	1.00 EA	0.00	37.06	0.36	7.50	44.92
313. R&R Door opening (jamb & casing) - 32"to36"wide - stain grade	1.00 EA	9.02	246.64	10.72	53.26	319.64
314. R&R Snaplock Laminate - simulated wood flooring	53.51 SF	1.69	6.76	10.05	92.44	554.65
315. Prep wall for wallpaper	30.00 SF	0.00	0.76	0.00	4.56	27.36
316. R&R Wallpaper	30.00 SF	1.16	2.80	2.03	24.16	144.99
317. Clean light bar - Heavy	1.00 EA	0.00	32.30	0.01	6.46	38.77
<b>Totals: Laundry Room</b>				<b>88.09</b>	<b>973.10</b>	<b>5,838.27</b>
<b>Total: Main Level</b>				<b>2,880.03</b>	<b>27,387.04</b>	<b>164,321.43</b>

**Labor Minimums Applied**

DESCRIPTION	QTY	REMOVE	REPLACE	TAX	O&P	TOTAL
318. Vinyl floor covering labor minimum	1.00 EA	0.00	228.89	0.00	45.78	274.67
319. Heat, vent, & air cond. labor minimum	1.00 EA	0.00	227.63	0.00	45.52	273.15



**Mr Estimates**

Dallas TX 75243  
 www.mrestimatepro.com

**CONTINUED - Labor Minimums Applied**

DESCRIPTION	QTY	REMOVE	REPLACE	TAX	O&P	TOTAL
320. Window treatment repair	1.00 EA	0.00	8.00	0.00	1.60	9.60
321. Plaster labor minimum	1.00 EA	0.00	540.20	0.00	108.04	648.24
322. Toilet & bath accessory labor minimum	1.00 EA	0.00	72.46	0.00	14.50	86.96
323. Wallpaper labor minimum	1.00 EA	0.00	102.09	0.00	20.42	122.51
Totals: Labor Minimums Applied				0.00	235.86	1,415.13
<b>Line Item Totals: 17601</b>				<b>2,880.03</b>	<b>27,622.90</b>	<b>165,736.56</b>

**Grand Total Areas:**

6,665.33 SF Walls	3,811.75 SF Ceiling	10,477.08 SF Walls and Ceiling
3,811.75 SF Floor	423.53 SY Flooring	766.50 LF Floor Perimeter
0.00 SF Long Wall	0.00 SF Short Wall	766.50 LF Ceil. Perimeter
3,811.75 Floor Area	4,064.75 Total Area	6,665.33 Interior Wall Area
7,292.83 Exterior Wall Area	791.50 Exterior Perimeter of Walls	
0.00 Surface Area	0.00 Number of Squares	0.00 Total Perimeter Length
0.00 Total Ridge Length	0.00 Total Hip Length	



## Mr Estimates

---

Dallas TX 75243  
www.mrestimatepro.com

### Summary

Line Item Total	135,233.63
Material Sales Tax	2,853.32
Storage Rental Tax	26.71
	<hr/>
Subtotal	138,113.66
Overhead	13,811.45
Profit	13,811.45
	<hr/>
<b>Replacement Cost Value</b>	<b>\$165,736.56</b>
<b>Net Claim</b>	<b>\$165,736.56</b>
	<hr/> <hr/>

---

Cliff Martin  
Estimator



**Mr Estimates**

Dallas TX 75243  
www.mrestimatepro.com

**Recap of Taxes, Overhead and Profit**

	<b>Overhead (10%)</b>	<b>Profit (10%)</b>	<b>Material Sales Tax (6%)</b>	<b>Laundering Tax (2%)</b>	<b>Manuf. Home Tax (6%)</b>	<b>Storage Rental Tax (6%)</b>
<b>Line Items</b>	13,811.45	13,811.45	2,853.32	0.00	0.00	26.71
<b>Total</b>	<b>13,811.45</b>	<b>13,811.45</b>	<b>2,853.32</b>	<b>0.00</b>	<b>0.00</b>	<b>26.71</b>

